

8. Battery Box

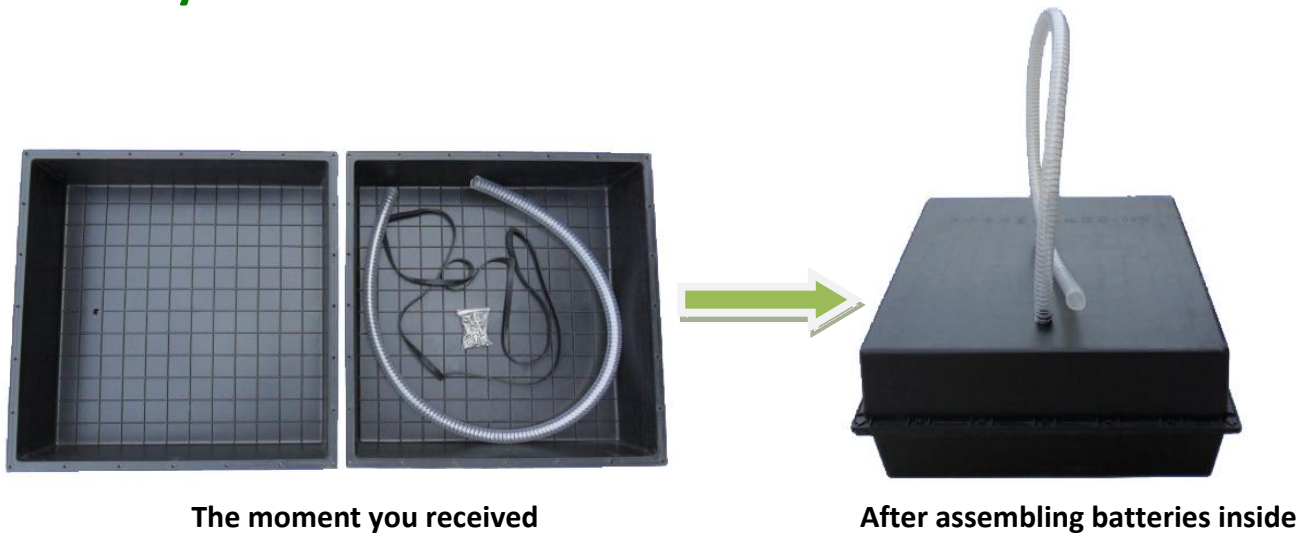

1) Material: PP Engineering Plastic

2) Inner Dimensions: 500*370*260mm / Outer : 530*430*280mm

3) Weight:1.8 kg

4) Features: Mold-pressing forming, fully sealed waterproof, good heat protection

5) Batteries installation View

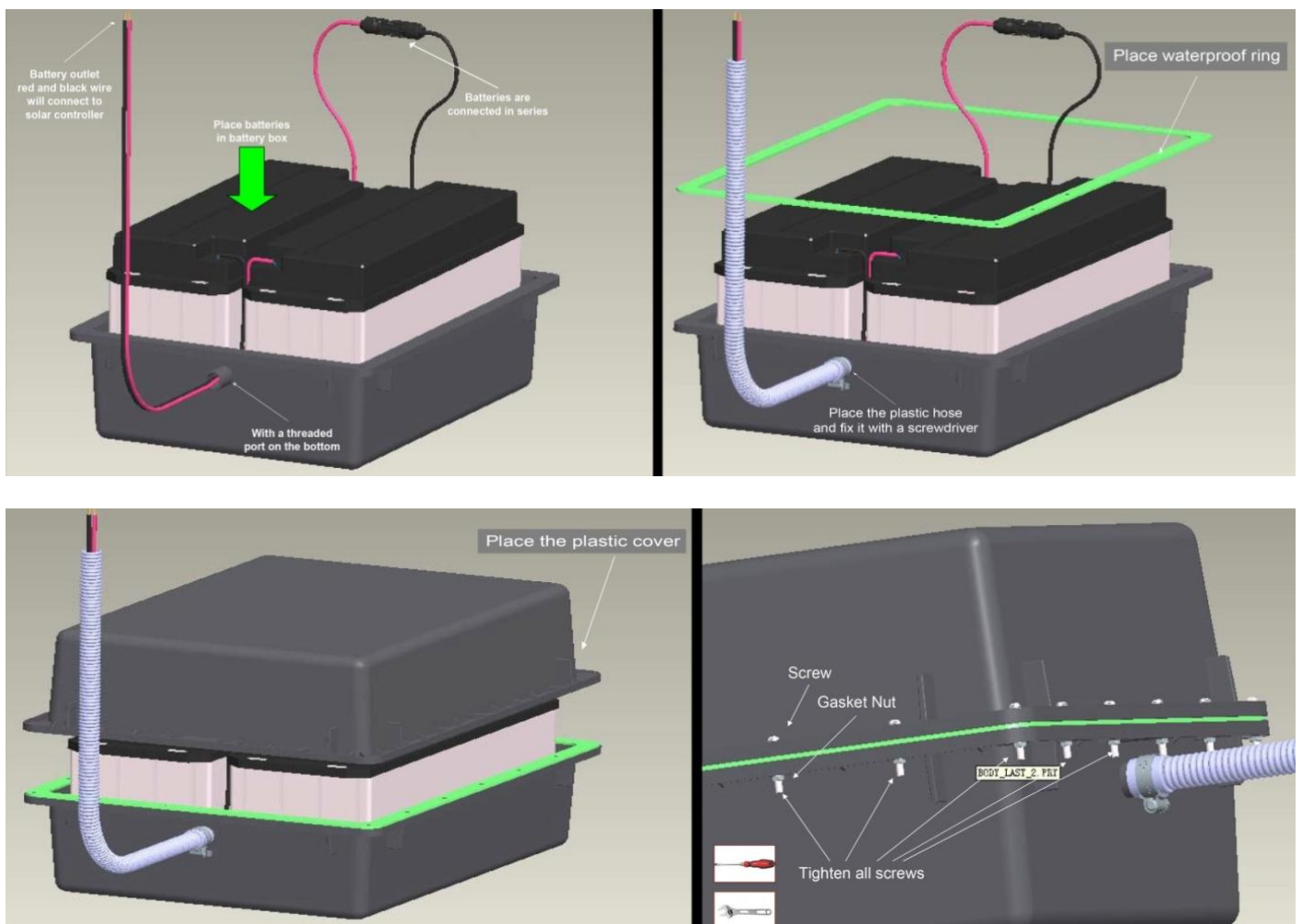

9. Cables

1) PV Module to charge controller: Red color

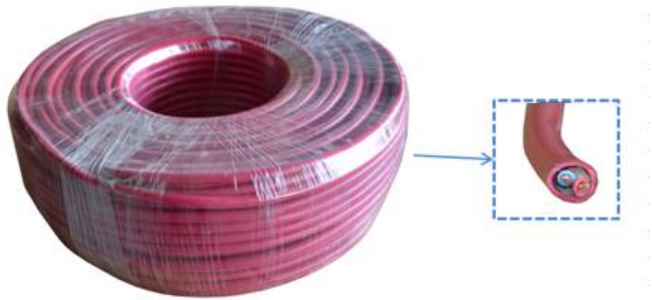

2) Battery/Controller to lamps: Black color

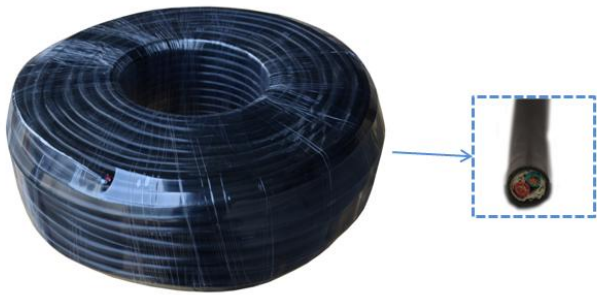

Features:

No bare wire connections to terminal/junction strips. Wiring losses are less than 3.5% for the Charging system (solar panel to controller to battery), and less than 2.5% for the load system (battery to controller to lighting load).

Method of use:

The first method:

1, Put the battery into the battery box, wire from threading hole in the ground box, After good sealing ring, Tighten the screws, then thread work clamp fixed tightening in the box above the outlet hole.

2, The last cabinet to be included in the build by laying bricks or stones good cement pool in advance, will cement pool of the lid.

The second method:

Put battery into battery box, wire from threading hole in the ground box, seal card, tighten the screws, thread work clamp fixed tightening in the box above the outlet hole;

2, Finally the case directly buried in the ground. (the second method is more convenient and quick cost savings)

